

Rev:	Description:	Date:	By:	To:
1	Issued for Review	29/04/25	ZG	WmcG
2	Issued for Planning	14/05/25	ZG	WmcG
3	Updated to An Coimisiún Pleanála RFI 2 (I)	05/02/26	ZG	WmcG

- NOTES:**
- ALL DRAWINGS SHOULD BE READ IN CONJUNCTION WITH ARCHITECTS PLANS AND SPECIFICATION AND ALL RELEVANT DOCUMENTATION RELATED TO THE CURRENT PROJECT.
  - ALL RESPONSIBILITY FOR THE DELIVERABLES LIES WITH CLIENT AND RELEVANT APPOINTED PARTIES.
  - DO NOT SCALE FROM DRAWINGS.
  - ALL DIMENSIONS IN S.I. UNITS UNO.

**PROPOSED WORKS**

The proposed works is the upgrade of the existing walking path to Clare Glens Amenity space including but not limited to, a new vehicular and pedestrian access to incorporate a new emergency staging area Upgrade to an existing foot bridge and installation of 2 viewing platforms with fencing, construct circa 250m of new path. Upgrade to the existing path in the form of widening to 1.8m in width along its entire length. Drainage Remediation with required and all associated site works.

**DRAWING LEGEND**

	Total Ownership Boundary
	Ownership out site of Tipp. Co. Co. (Refer to letters of consent as noted on plan)
	Outline of Proposed Works
	Existing Path to be Upgraded.
	Proposed Path Upgrade to 1.8m Width.
	Proposed New Culvert
	Proposed Post and Rail Fence

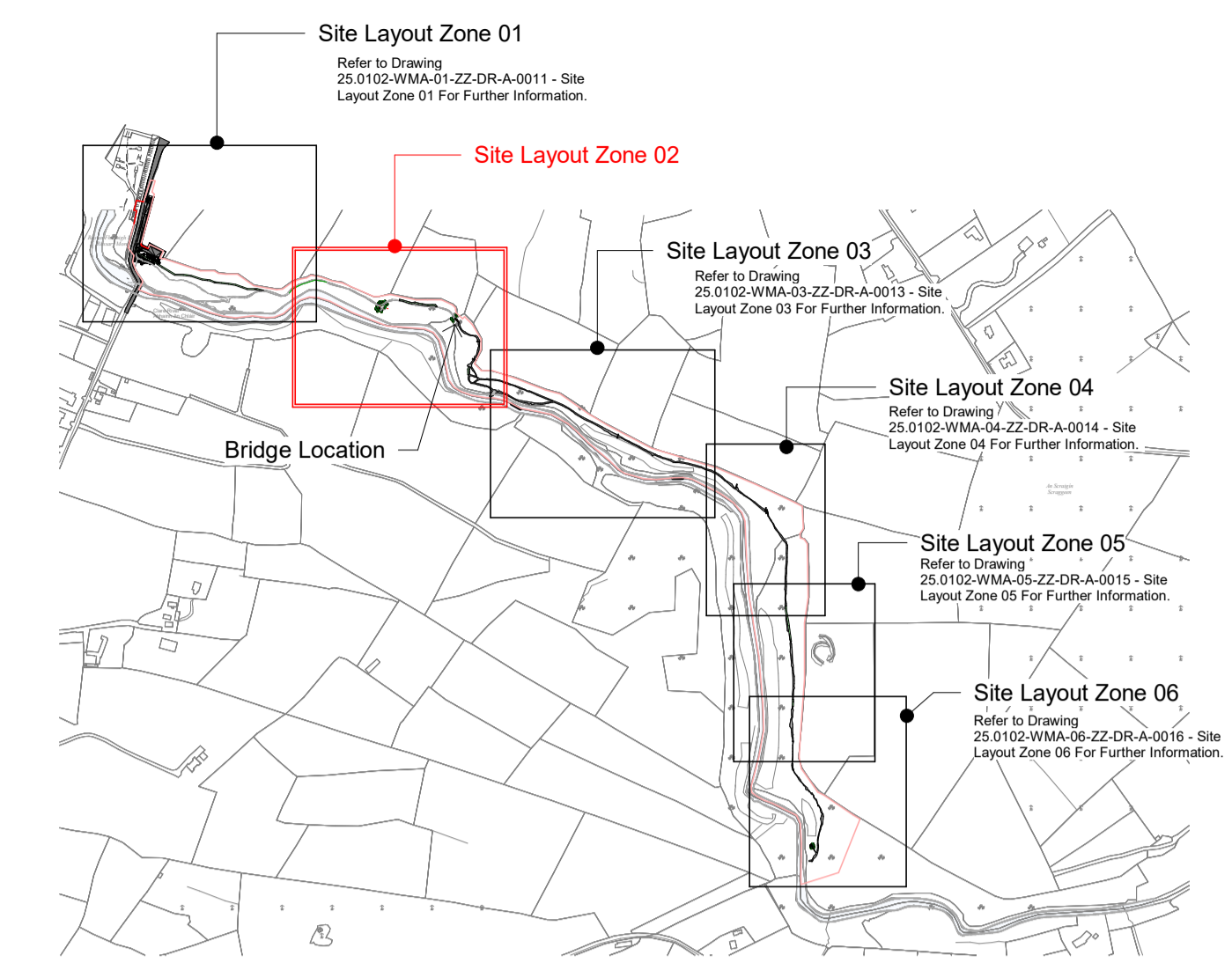

**Site Layout Key Plan Zone 02**  
1 : 10000

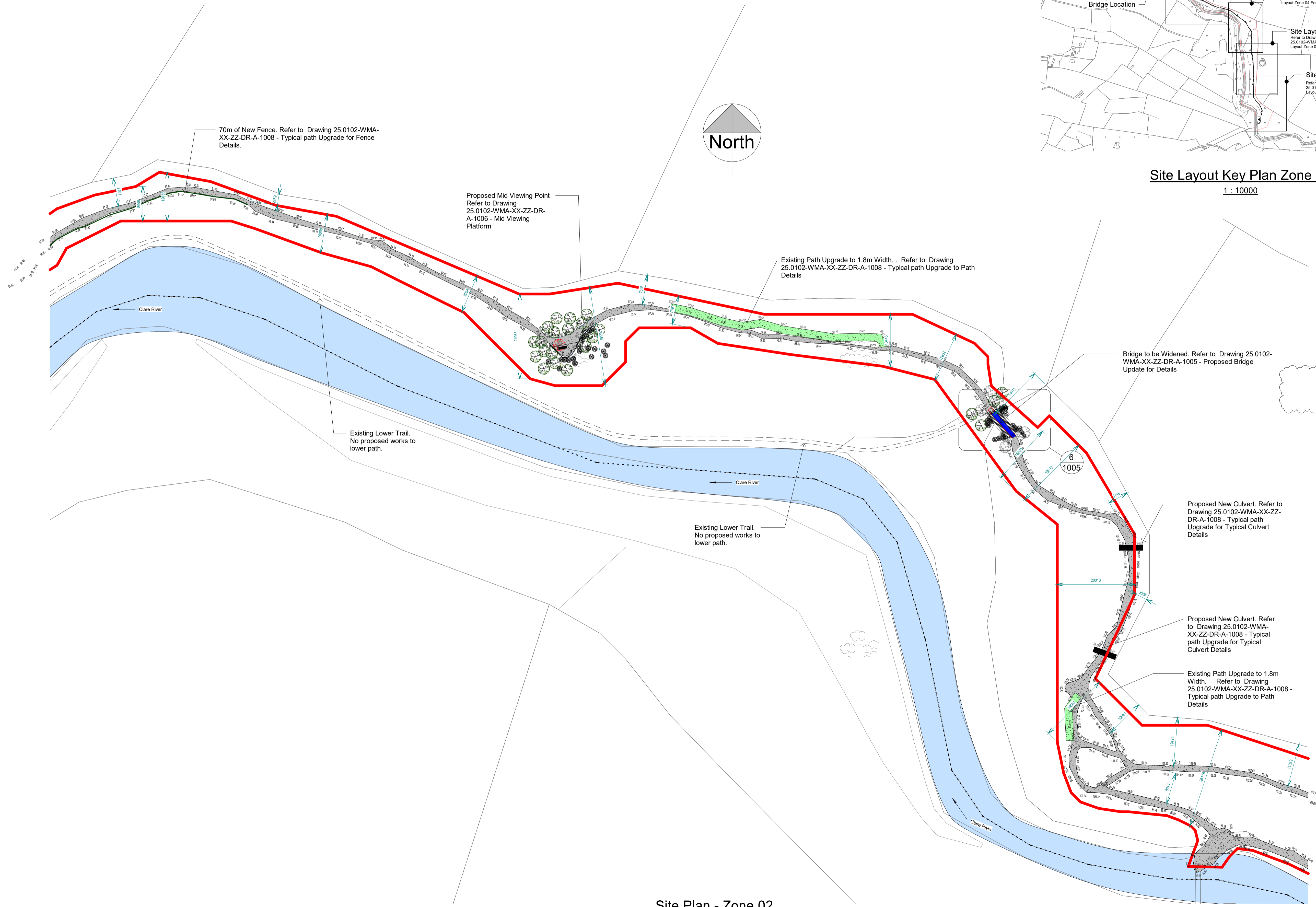

**Site Plan - Zone 02**  
1 : 500

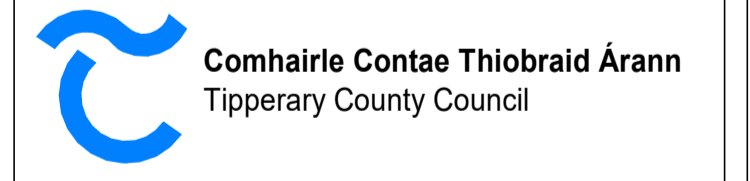

**WILL MC GARRY & ASSOCIATES**  
ENGINEERS  
15 MARY STREET CLONMEL  
PHONE: 052 6181828 MOBILE: 086 2737455 EMAIL: INFO@WMAA.IE

Planning	REV: 3
----------	--------

Tipperary County Council

Clare Glens River Walk

Site Layout Zone 02

Project number: 25.0102

Date: 12/02/25

Drawn by: ZG

Checked by: WmcG

Scale @ A1: As indicated

Sheet No: 25.0102- WMA- 02- ZZ- DR- A- 0012